

Torçe MIG/MAG "MB GRIP" aria

Duty Cycle da 150 A fino a 230 A

Le torçe MIG/MAG della serie "MB GRIP" nelle varianti ad aria e a liquido sono la miglior soluzione possibile. Combinano tecnologia, qualità ed ergonomia, per un lavoro senza problemi e per ogni tipo di applicazione.

Il giunto a snodo e l'impugnatura "GRIP" garantiscono grande maneggevolezza e presa sicura. Tutte le torçe sono progettate per consentire un uso comodo e preciso.

- L'impugnatura ergonomica "GRIP" corta, per un migliore accesso
- "GRIP", con componenti morbidi e punto di alloggiamento per riposo del pollice, maneggevole anche in condizioni estreme
- Giunto a snodo, con raggio ottimale - perfetta maneggevolezza
- L'ottimo raffreddamento della torcia - aumenta la vita della stessa
- Le torçe ad aria BIKOX® R - ad alta flessibilità anche a basse temperature, resistenti ai raggi UV, maggior stabilità alle alte temperature e alle trazioni
- Cambio torcia rapido grazie al connettore centralizzato ABICOR BINZEL



MB GRIP 15 AK

Dati tecnici (EN 60 974-7):

Classificazione:	180 A CO ₂
	150 A Miscela Gas
	M21 (DIN EN 439)
Duty cycle:	60%
Diametro filo:	0.6 - 1.0 mm

MB GRIP 25 AK

Dati tecnici (EN 60 974-7):

Classificazione:	230 A CO ₂
	200 A Miscela Gas
	M21 (DIN EN 439)
Duty cycle:	60%
Diametro filo:	0.8 - 1.2 mm

Torcia completa

Modello	Impugnatura	n° cod.			Mod.	Lancia n° cod.
		3 m	4 m	5 m		
MB GRIP 15 AK	Tipo MB	002.0604	002.0605	002.0606	50°	002.0009
MB GRIP 25 AK	Tipo MB	004.0510	004.0511	004.0512	50°	004.0012

MB GRIP 15, MB GRIP 25

Consumabili

MB GRIP 15 AK

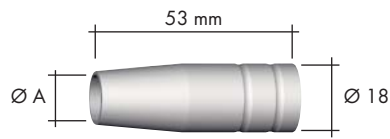

MB GRIP 25 AK

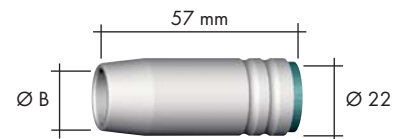

Ug.gas (10 pcs.)

	Ø A		Ø B	
Cilindrico	Ø 16	145.0041	Ø 18	145.0042
Conico	Ø 12	145.0075	Ø 15	145.0076
Conico	Ø 9.5	145.0123	Ø 11.5	145.0124

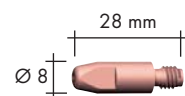
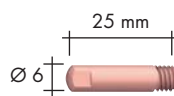

Ug.p.corr. (10 pcs.)

		M6	M6
E-Cu	Ø 0.6	140.0008	-
	Ø 0.8	140.0059	140.0051
	Ø 1.0	140.0253	140.0242
	Ø 1.2	-	140.0379
E-Cu per Al	Ø 0.8	141.0002	141.0001
	Ø 1.0	141.0007	141.0006
	Ø 1.2	-	141.0010
CuCrZr	Ø 0.6	140.0855	-
	Ø 0.8	140.0062	140.0054
	Ø 1.0	140.0256	140.0245
	Ø 1.2	-	140.0382



Molla per ugello (20 pcs.)

	002.0058	003.0013
--	----------	----------

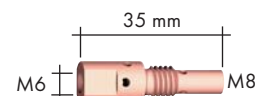

Supp.ug.gas / supp.ug.p.corrente

M6	002.0078	142.0001 (10 pcs.)
----	----------	--------------------



Guaine		per 3 m	per 4 m	per 5 m
Guaine isolate	Ø 0.6	124.0011	124.0012	124.0015
	Ø 0.8	124.0011	124.0012	124.0015
	Ø 1.0	124.0026	124.0031	124.0035
	Ø 1.2	124.0026	124.0031	124.0035
Guaine PTFE	Ø 0.6	126.0005	126.0008	126.0011
	Ø 0.8	126.0005	126.0008	126.0011
	Ø 1.0	126.0021	126.0026	126.0028
	Ø 1.2	126.0021	126.0026	126.0028
Guaine grafite PTFE	Ø 0.6	127.0002	127.0003	127.0004
	Ø 0.8	127.0002	127.0003	127.0004
	Ø 1.0	127.0005	127.0007	127.0008
	Ø 1.2	127.0005	127.0007	127.0008

MIG/MAG Welding Torches MB GRIP 15 AK

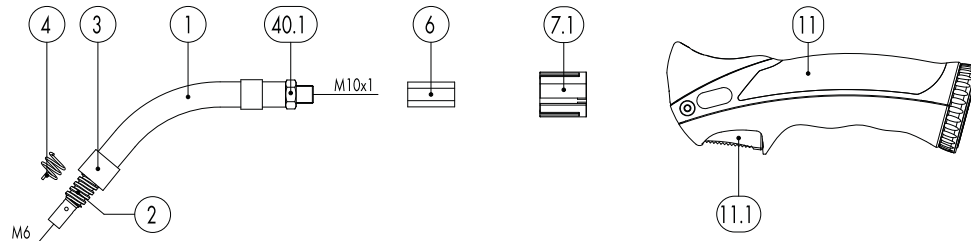

Pos.	Description	Units	Part-No.	Product-group
Torch				
	MB 15 AK GRIP; central adaptor KZ-2; 3.00 m		002.0604	1008
	MB 15 AK GRIP; central adaptor KZ-2; 4.00 m		002.0605	1008
	MB 15 AK GRIP; central adaptor KZ-2; 5.00 m		002.0606	1008
Swan neck				
1	Swan neck MB 15 AK; 50j bent		002.0009	1007
	Swan neck MB 15 AK; flexible		002.0029	1007
2	Gas nozzle holder		002.0078	1095
3	Head insulator	10 Pcs.	002.0050	1095
4	Nozzle spring	100 Pcs.	002.0058	1095
6	Torch body brass		400.0114	1095
7.1	Torch body plastic GRIP		400.0044	1095
Handle GRIP				
11	Handle GRIP with trigger cpl.		180.0127	1095
11.1	Trigger 2-pole GRIP		185.0101	9010
Cable assembly				
40	Bikox® R-power cable MB GRIP / ABIMIG®, R4 for 3.00 m		160.D520	1511
40	Bikox® R-power cable MB GRIP / ABIMIG®, R4 for 4.00 m		160.D521	1511
40	Bikox® R-power cable MB GRIP / ABIMIG®, R4 for 5.00 m		160.D522	1511
	Outer cover rubber ~ 20x1.5	40 m	105.0005	4050
40.1	Hexagon nut M10x1	10 Pcs.	001.0009	9010
44	Trigger wire connector	20 Pcs.	175.0022	9010
45	Insulating sleeve	20 Pcs.	400.0119	1095
46	Plug	20 Pcs.	175.0004	9010
54	Cable support ND 19		400.1010	1095
54.1	Ball joint cable protection MB GRIP (air cooled)		400.1395.1	1095

MIG/MAG Welding Torches MB GRIP 15 AK

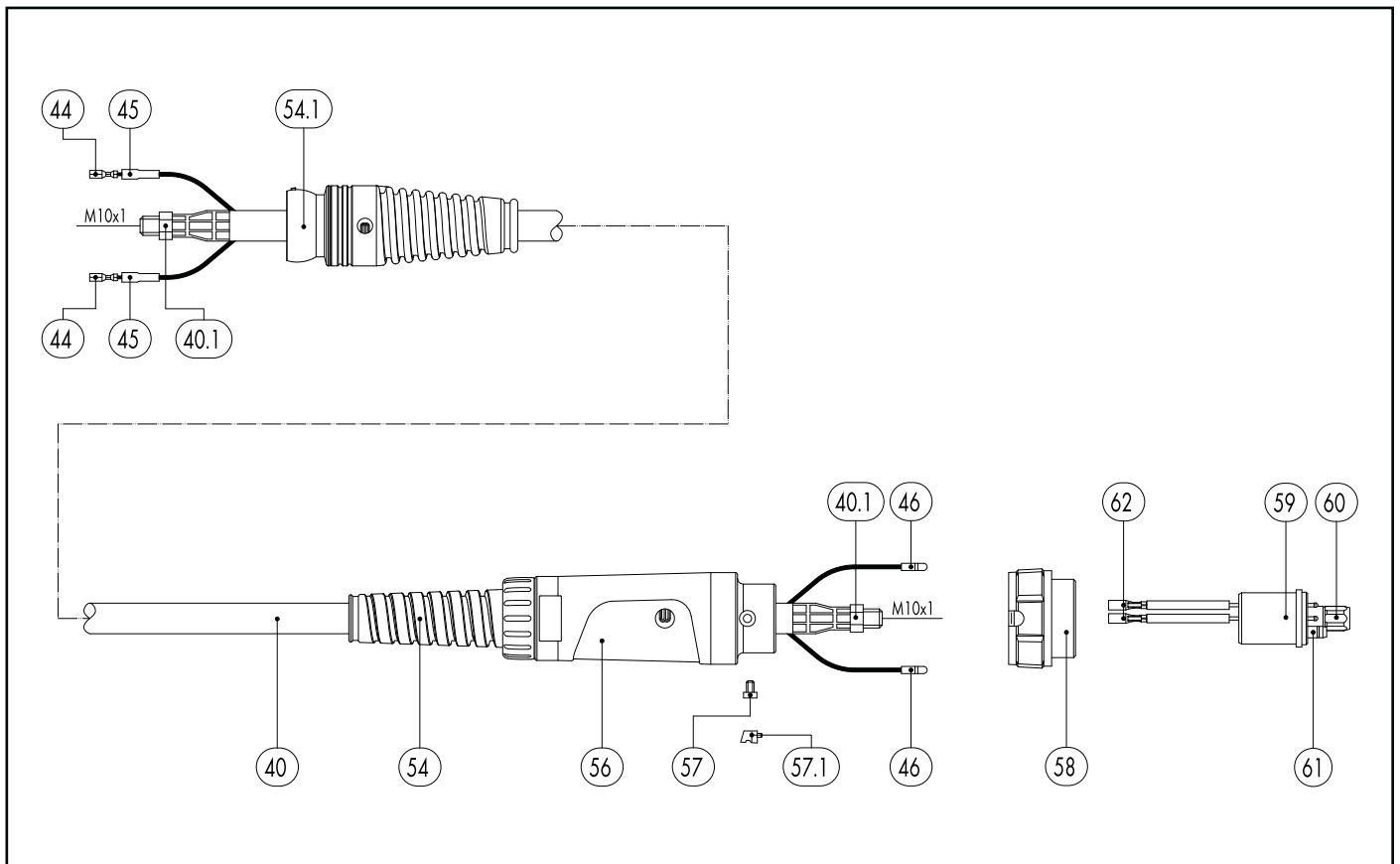

Pos.	Description	Units	Part-No.	Product-group
56	Cable support machine side		501.2248	9010
57	Pan head screw M4x6	20 Pcs.	000.0552	9010
57.1	Screw cap 1	20 Pcs.	500.0251	9010
58	Adaptor nut M33x2		500.0213	9010
59	Central adaptor KZ-2		501.0003	1095
60	Coupling nut M10x1	10 Pcs.	501.0082	9010
61	O-Ring 4x1	20 Pcs.	165.0002	9010
62	Trigger wire connector; female	20 Pcs.	175.0003	9010
Wear parts				
90	Contact tip M6 E-Cu; $\bar{\text{~}}$ 0.6 (6x25)	10 Pcs.	140.0008	1030
90	Contact tip M6 E-Cu; $\bar{\text{~}}$ 0.8 (6x25)	10 Pcs.	140.0059	1030
90	Contact tip M6 E-Cu; $\bar{\text{~}}$ 1.0 (6x25)	10 Pcs.	140.0253	1030
90	Contact tip M6 CuCrZr; $\bar{\text{~}}$ 0.6 (6x25)	10 Pcs.	140.0855	1031
90	Contact tip M6 CuCrZr; $\bar{\text{~}}$ 0.8 (6x25)	10 Pcs.	140.0062	1031
90	Contact tip M6 CuCrZr; $\bar{\text{~}}$ 1.0 (6x25)	10 Pcs.	140.0256	1031
90	Contact tip M6 E-Cu; $\bar{\text{~}}$ 0.8 for alu wire (6x25)	10 Pcs.	141.0002	1030
90	Contact tip M6 E-Cu; $\bar{\text{~}}$ 1.0 for alu wire (6x25)	10 Pcs.	141.0007	1030
90	Contact tip M6 CuCrZr silver-plated; $\bar{\text{~}}$ 0.8 (6x25)	10 Pcs.	147.0062	1031
90	Contact tip M6 CuCrZr silver-plated; $\bar{\text{~}}$ 1.0 (6x25)	10 Pcs.	147.0256	1031
100	Gas nozzle; cylindrical; ND $\bar{\text{~}}$ 16.0	10 Pcs.	145.0041	1036
103	Gas nozzle; conical; ND $\bar{\text{~}}$ 12.0	10 Pcs.	145.0075	1036
104	Gas nozzle; conical; with extended insulation; ND $\bar{\text{~}}$ 12.0	10 Pcs.	145.0107	1036
106	Gas nozzle; tapered; ND $\bar{\text{~}}$ 9.5	10 Pcs.	145.0123	1036
108	Spot weld gas nozzle; ND $\bar{\text{~}}$ 16.0	10 Pcs.	145.0168	1036
110	Spot weld gas nozzle for pin-welding; ND $\bar{\text{~}}$ 16.0	10 Pcs.	145.0186	1036
120	Guide spiral liner insulated; 1.5/4.5; blue; for wire $\bar{\text{~}}$ 0.6 - 0.8; for 3.00 m		124.0011	1034

MIG/MAG Welding Torches MB GRIP 15 AK

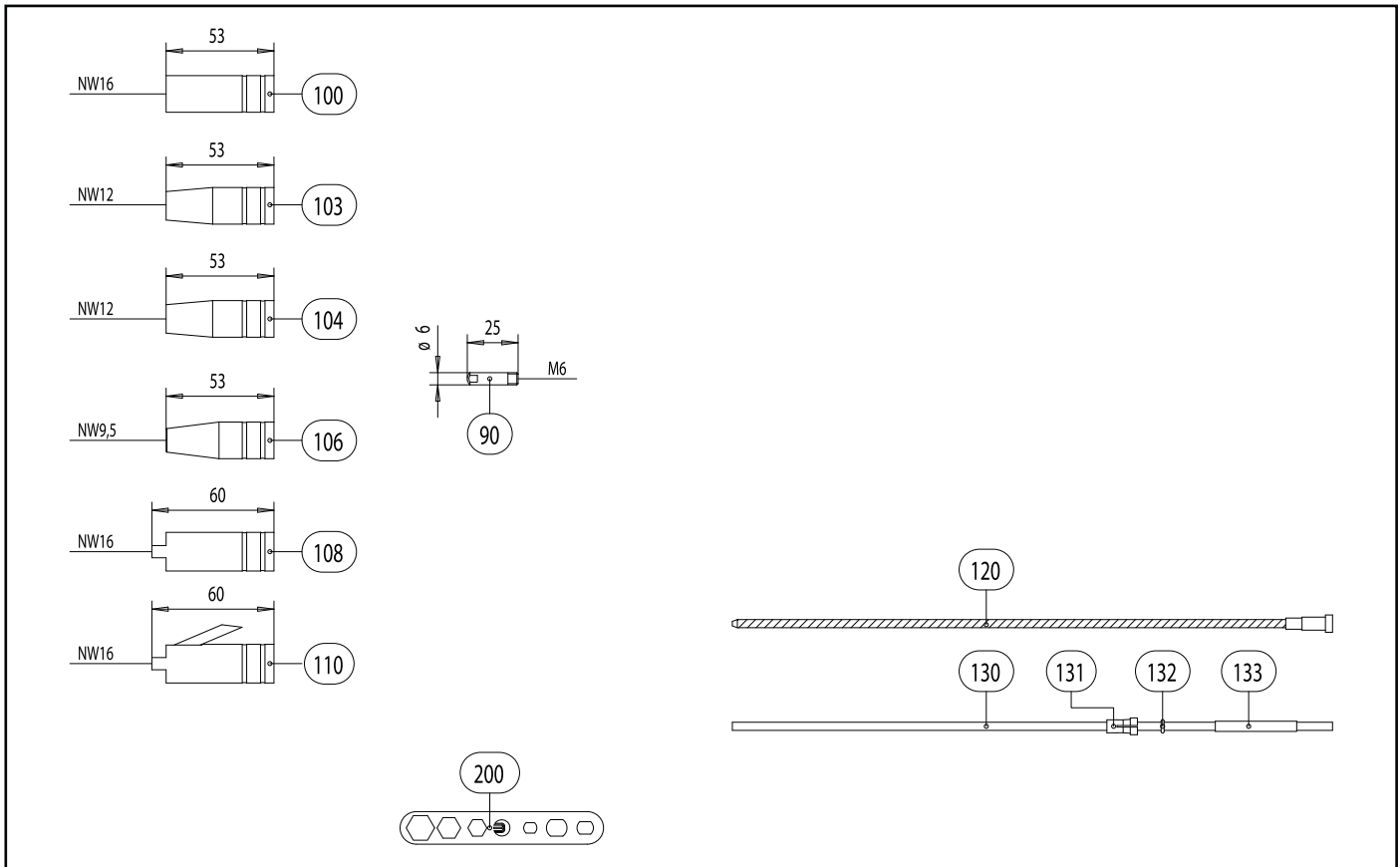

Pos. Description

Units

Part-No.

Product-group

120	Guide spiral liner insulated; 1.5/4.5; blue; for wire $\bar{\text{~}}$ 0.6 - 0.8; for 4.00 m		124.0012	1034
120	Guide spiral liner insulated; 1.5/4.5; blue; for wire $\bar{\text{~}}$ 0.6 - 0.8; for 5.00 m		124.0015	1034
120	Guide spiral liner insulated; 2.0/4.5; red; for wire $\bar{\text{~}}$ 1.0 - 1.2; for 3.00 m		124.0026	1034
120	Guide spiral liner insulated; 2.0/4.5; red; for wire $\bar{\text{~}}$ 1.0 - 1.2; for 4.00 m		124.0031	1034
120	Guide spiral liner insulated; 2.0/4.5; red; for wire $\bar{\text{~}}$ 1.0 - 1.2; for 5.00 m		124.0035	1034
130	PTFE core liner 1.5/4.0; blue; wire electrode $\bar{\text{~}}$ 0.8 - 1.0; for 3.00 m		126.0005	1034
130	PTFE core liner 1.5/4.0; blue; wire electrode $\bar{\text{~}}$ 0.8 - 1.0; for 4.00 m		126.0008	1034
130	PTFE core liner 1.5/4.0; blue; wire electrode $\bar{\text{~}}$ 0.8 - 1.0; for 5.00 m		126.0011	1034
130	PTFE core liner 2.0/4.0; red; wire electrode $\bar{\text{~}}$ 1.0 - 1.2; for 3.00 m		126.0021	1034
130	PTFE core liner 2.0/4.0; red; wire electrode $\bar{\text{~}}$ 1.0 - 1.2; for 4.00 m		126.0026	1034
130	PTFE core liner 2.0/4.0; red; wire electrode $\bar{\text{~}}$ 1.0 - 1.2; for 5.00 m		126.0028	1034
130	PTFE carbon core liner 1.5/4.0; wire electrode $\bar{\text{~}}$ 0.8 - 1.0; for 3.00 m		127.0002	1034
130	PTFE carbon core liner 1.5/4.0; wire electrode $\bar{\text{~}}$ 0.8 - 1.0; for 4.00 m		127.0003	1034
130	PTFE carbon core liner 1.5/4.0; wire electrode $\bar{\text{~}}$ 0.8 - 1.0; for 5.00 m		127.0004	1034
130	PTFE carbon core liner 2.0/4.0; wire electrode $\bar{\text{~}}$ 1.0 - 1.2; for 3.00 m		127.0005	1034
130	PTFE carbon core liner 2.0/4.0; wire electrode $\bar{\text{~}}$ 1.0 - 1.2; for 4.00 m		127.0007	1034
130	PTFE carbon core liner 2.0/4.0; wire electrode $\bar{\text{~}}$ 1.0 - 1.2; for 5.00 m		127.0008	1034
131	Nipple for core liner at $\bar{\text{~}}$ 4.0	20 Pcs.	131.0001	1095
132	O-Ring 3.5x1.5	20 Pcs.	165.0008	9010
133	Guide tube for core liners up to $\bar{\text{~}}$ 4.0 (200 mm)	10 Pcs.	129.0461	1095
200	Spanner Standard		191.0001	9010

MIG/MAG Welding Torches MB GRIP 25 AK

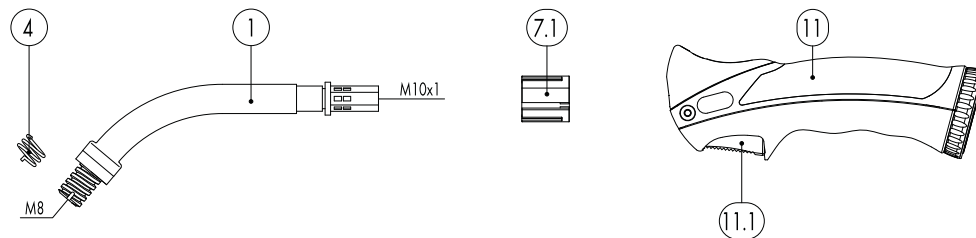

Pos.	Description	Units	Part-No.	Product-group
Torch				
	MB 25 AK GRIP; central adaptor KZ-2; 3.00 m		004.0510	1008
	MB 25 AK GRIP; central adaptor KZ-2; 4.00 m		004.0511	1008
	MB 25 AK GRIP; central adaptor KZ-2; 5.00 m		004.0512	1008
Swan neck				
1	Swan neck MB 25 AK; 50j bent		004.0012	1007
	Swan neck MB 25 AK; flexible		004.0032	1007
4	Nozzle spring	100 Pcs.	003.0013	1095
7.1	Torch body plastic GRIP		400.0044	1095
Handle GRIP				
11	Handle GRIP with trigger cpl.		180.0127	1095
11.1	Trigger 2-pole GRIP		185.0101	9010
Cable assembly				
40	Bikox® R-power cable MB GRIP / ABIMIG®, R5 for 3.00 m		160.D427	1511
40	Bikox® R-power cable MB GRIP / ABIMIG®, R5 for 4.00 m		160.D428	1511
40	Bikox® R-power cable MB GRIP / ABIMIG®, R5 for 5.00 m		160.D429	1511
	Outer cover rubber ~ 20x1.5	40 m	105.0005	4050
40.1	Hexagon nut M10x1	10 Pcs.	001.0009	9010
44	Trigger wire connector	20 Pcs.	175.0022	9010
45	Insulating sleeve	20 Pcs.	400.0119	1095
46	Plug	20 Pcs.	175.0004	9010
54	Cable support ND 19		400.1010	1095
54.1	Ball joint cable protection MB GRIP (air cooled)		400.1395.1	1095
56	Cable support machine side		501.2248	9010
57	Pan head screw M4x6	20 Pcs.	000.0552	9010
57.1	Screw cap 1	20 Pcs.	500.0251	9010

MIG/MAG Welding Torches MB GRIP 25 AK

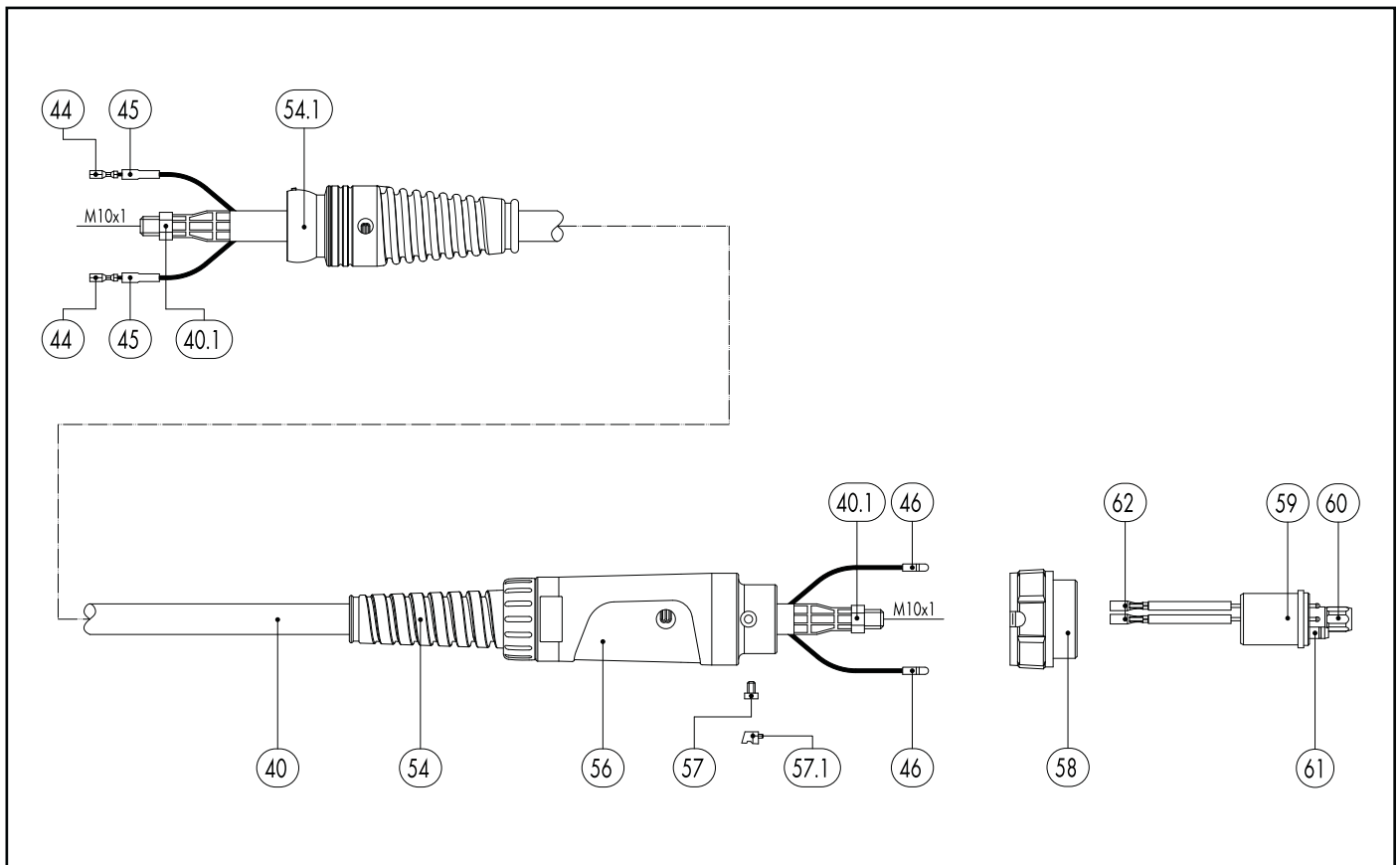

Pos.	Description	Units	Part-No.	Product-group
58	Adaptor nut M33x2		500.0213	9010
59	Central adaptor KZ-2		501.0003	1095
60	Coupling nut M10x1	10 Pcs.	501.0082	9010
61	O-Ring 4x1	20 Pcs.	165.0002	9010
62	Trigger wire connector; female	20 Pcs.	175.0003	9010
Wear parts				
80	Contact tip holder M6; 35.0 mm	10 Pcs.	142.0001	1033
90	Contact tip M6 E-Cu; $\bar{\text{~}}$ 0.8 (8x28)	10 Pcs.	140.0051	1030
90	Contact tip M6 E-Cu; $\bar{\text{~}}$ 1.0 (8x28)	10 Pcs.	140.0242	1030
90	Contact tip M6 E-Cu; $\bar{\text{~}}$ 1.2 (8x28)	10 Pcs.	140.0379	1030
90	Contact tip M6 CuCrZr; $\bar{\text{~}}$ 0.8 (8x28)	10 Pcs.	140.0054	1031
90	Contact tip M6 CuCrZr; $\bar{\text{~}}$ 1.0 (8x28)	10 Pcs.	140.0245	1031
90	Contact tip M6 CuCrZr; $\bar{\text{~}}$ 1.2 (8x28)	10 Pcs.	140.0382	1031
90	Contact tip M6 E-Cu; $\bar{\text{~}}$ 0.8 for alu wire (8x28)	10 Pcs.	141.0001	1030
90	Contact tip M6 E-Cu; $\bar{\text{~}}$ 1.0 for alu wire (8x28)	10 Pcs.	141.0006	1030
90	Contact tip M6 E-Cu; $\bar{\text{~}}$ 1.2 for alu wire (8x28)	10 Pcs.	141.0010	1030
90	Contact tip M6 CuCrZr silver-plated; $\bar{\text{~}}$ 0.8 (8x28)	10 Pcs.	147.0054	1031
90	Contact tip M6 CuCrZr silver-plated; $\bar{\text{~}}$ 1.0 (8x28)	10 Pcs.	147.0245	1031
90	Contact tip M6 CuCrZr silver-plated; $\bar{\text{~}}$ 1.2 (8x28)	10 Pcs.	147.0382	1031
100	Gas nozzle; cylindrical; ND $\bar{\text{~}}$ 18.0	10 Pcs.	145.0042	1036
102	Gas nozzle; conical; ND $\bar{\text{~}}$ 15.0	10 Pcs.	145.0076	1036
103	Gas nozzle; conical; with extended insulation; ND $\bar{\text{~}}$ 15.0	10 Pcs.	145.0100	1036
104	Gas nozzle; tapered; ND $\bar{\text{~}}$ 11.5	10 Pcs.	145.0124	1036
109	Spot weld gas nozzle; ND $\bar{\text{~}}$ 18.0	10 Pcs.	145.0169	1036
120	Guide spiral liner insulated; 1.5/4.5; blue; for wire $\bar{\text{~}}$ 0.6 - 0.8; for 3.00 m		124.0011	1034
120	Guide spiral liner insulated; 1.5/4.5; blue; for wire $\bar{\text{~}}$ 0.6 - 0.8; for 4.00 m		124.0012	1034

MIG/MAG Welding Torches MB GRIP 25 AK

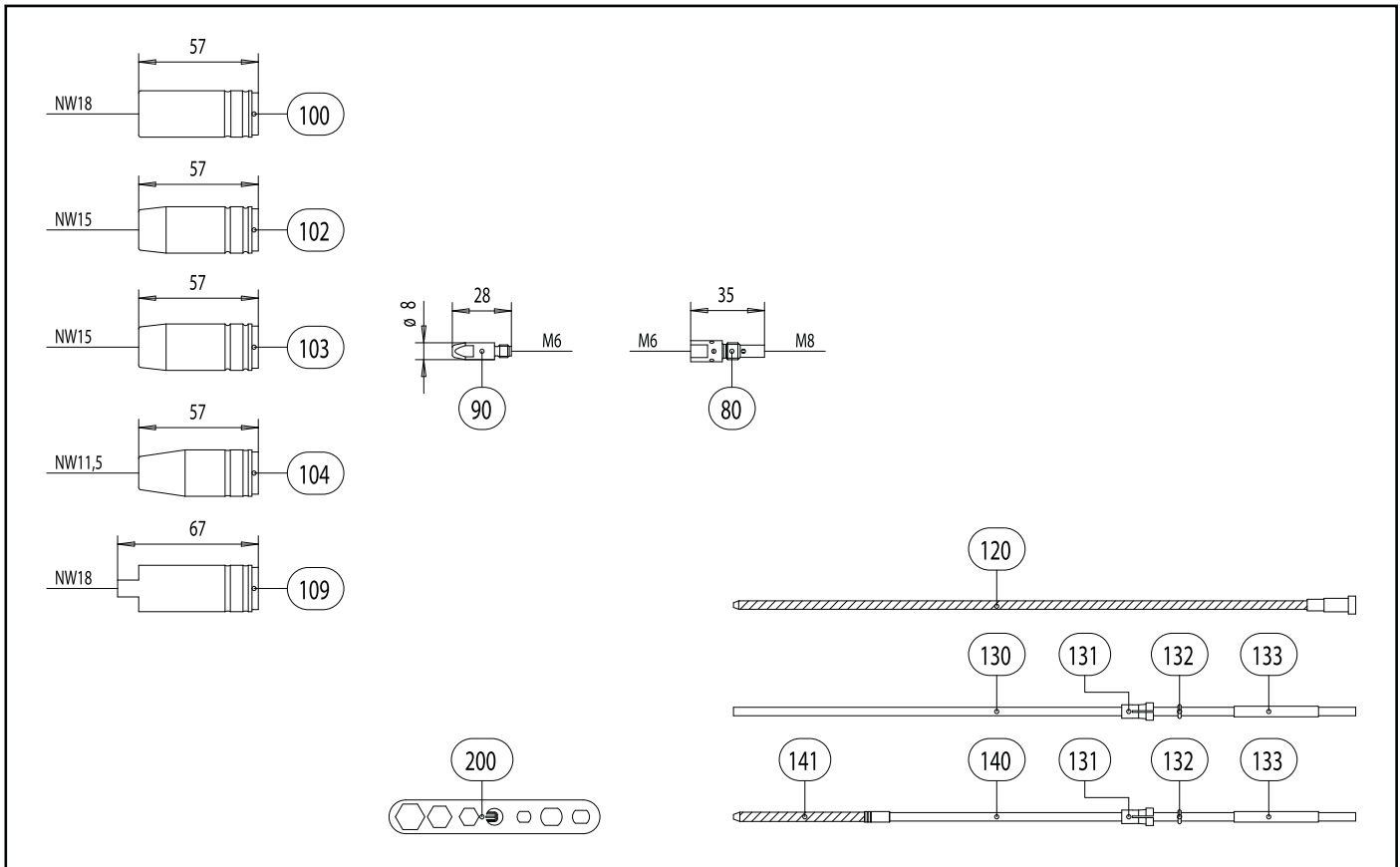

Pos. Description

Units

Part-No.

Product-group

Pos.	Description	Units	Part-No.	Product-group
120	Guide spiral liner insulated; 1.5/4.5; blue; for wire \varnothing 0.6 - 0.8; for 5.00 m		124.0015	1034
120	Guide spiral liner insulated; 2.0/4.5; red; for wire \varnothing 1.0 - 1.2; for 3.00 m		124.0026	1034
120	Guide spiral liner insulated; 2.0/4.5; red; for wire \varnothing 1.0 - 1.2; for 4.00 m		124.0031	1034
120	Guide spiral liner insulated; 2.0/4.5; red; for wire \varnothing 1.0 - 1.2; for 5.00 m		124.0035	1034
130	PTFE core liner 1.5/4.0; blue; wire electrode \varnothing 0.8 - 1.0; for 3.00 m		126.0005	1034
130	PTFE core liner 1.5/4.0; blue; wire electrode \varnothing 0.8 - 1.0; for 4.00 m		126.0008	1034
130	PTFE core liner 1.5/4.0; blue; wire electrode \varnothing 0.8 - 1.0; for 5.00 m		126.0011	1034
130	PTFE core liner 2.0/4.0; red; wire electrode \varnothing 1.0 - 1.2; for 3.00 m		126.0021	1034
130	PTFE core liner 2.0/4.0; red; wire electrode \varnothing 1.0 - 1.2; for 4.00 m		126.0026	1034
130	PTFE core liner 2.0/4.0; red; wire electrode \varnothing 1.0 - 1.2; for 5.00 m		126.0028	1034
130	PTFE carbon core liner 1.5/4.0; wire electrode \varnothing 0.8 - 1.0; for 3.00 m		127.0002	1034
130	PTFE carbon core liner 1.5/4.0; wire electrode \varnothing 0.8 - 1.0; for 4.00 m		127.0003	1034
130	PTFE carbon core liner 1.5/4.0; wire electrode \varnothing 0.8 - 1.0; for 5.00 m		127.0004	1034
130	PTFE carbon core liner 2.0/4.0; wire electrode \varnothing 1.0 - 1.2; for 3.00 m		127.0005	1034
130	PTFE carbon core liner 2.0/4.0; wire electrode \varnothing 1.0 - 1.2; for 4.00 m		127.0007	1034
130	PTFE carbon core liner 2.0/4.0; wire electrode \varnothing 1.0 - 1.2; for 5.00 m		127.0008	1034
131	Nipple for core liner at \varnothing 4.0	20 Pcs.	131.0001	1095
132	O-Ring 3.5x1.5	20 Pcs.	165.0008	9010
133	Guide tube for core liners up to \varnothing 4.0 (200 mm)	10 Pcs.	129.0461	1095
140	Combined wire guide cpl. polyamide/brass; wire \varnothing 1.0 - 1.2; for 3.00 m		128.M002	1034
140	Combined wire guide cpl. polyamide/brass; wire \varnothing 1.0 - 1.2; for 4.00 m		128.M003	1034
140	Combined wire guide cpl. polyamide/brass; wire \varnothing 1.0 - 1.2; for 5.00 m		128.M004	1034
141	Brass spiral made up with sleeve (200 mm)	10 Pcs.	001.0305	1095
200	Spanner Standard		191.0001	9010