

# Torçe MIG/MAG "ABIMIG® GRIP W"

## liquido • Duty Cycle 400 A fino a 575 A

Torçe MIG/MAG ABIMIG® GRIP W raffreddate a liquido con l'innovativa impugnatura "GRIP" a due componenti, la combinazione ideale tra ergonomia e facilità di utilizzo delle varianti modulo di controllo ( interruttore torcia e funzioni di controllo ). I due componenti dell'impugnatura "GRIP" e il giunto a snodo garantiscono una impugnabilità sicura ed ottimale in ogni condizione di lavoro.

Le torçe della serie ABIMIG® GRIP W eccellono particolarmente nelle applicazioni MIG Pulsato, grazie al loro doppio circuito di raffreddamento assicurano un raffreddamento supplementare alle parti consumabile riducendo drasticamente l'usura delle stesse.

Tutte le torçe sono state attentamente studiate e realizzate per un utilizzo preciso e confortevole.

- Doppio circuitodi raffreddamento, un maggior afflusso del liquido abbinato ad un nuovo sistema di trasferimento del calore, per una maggiore potenza e dissipazione del calore - meno adesione degli spruzzi e maggior durata delle parti consumabile.
- Protezione esterno lancia addizionale, miglior resistenza ai raggi UV ed al calore - per una maggiore durata e vita di servizio torcia.
- La nuova lancia abbinata all'innovativo sistema impugnatura ABIMIG® GRIP con giunto a snodo garantiscono un ottimo bilanciamento anche in condizioni di impiego difficili.
- Ad esclusione del supporto ugello porta corrente tutte le altre parti consumabile della serie ABIMIG® GRIP W 555 sono compatibili con la serie MB 401/501 - meno stock.
- Supporto ugello porta corrente robusto e ad alta resilienza meccanica ( due versioni - brasato su lancia o intercambiabile ) - per una lunga durata di servizio.

### ABIMIG® GRIP W 555 D

#### Dati tecnici (EN 60 974-7):

Classificazione:	550 A CO <sub>2</sub>
	500 A Miscela Gas
	400 A Pulsato
	M21 (DIN EN 439)
Duty cycle:	100%
Diametro filo:	0.8 - 1.6 mm

### ABIMIG® GRIP W 555

#### Dati tecnici (EN 60 974-7):

Classificazione:	575 A CO <sub>2</sub>
	525 A Miscela Gas
	400 A Pulsato
	M21 (DIN EN 439)
Duty cycle:	100%
Diametro filo:	0.8 - 1.6 mm

#### \*Nota:

Per proteggere i componenti del fasciame torcia da un eccessivo surriscaldamento, consigliamo di mantenere attivo il circuito di raffreddamento macchina per almeno 1 minuto da termine saldatura..

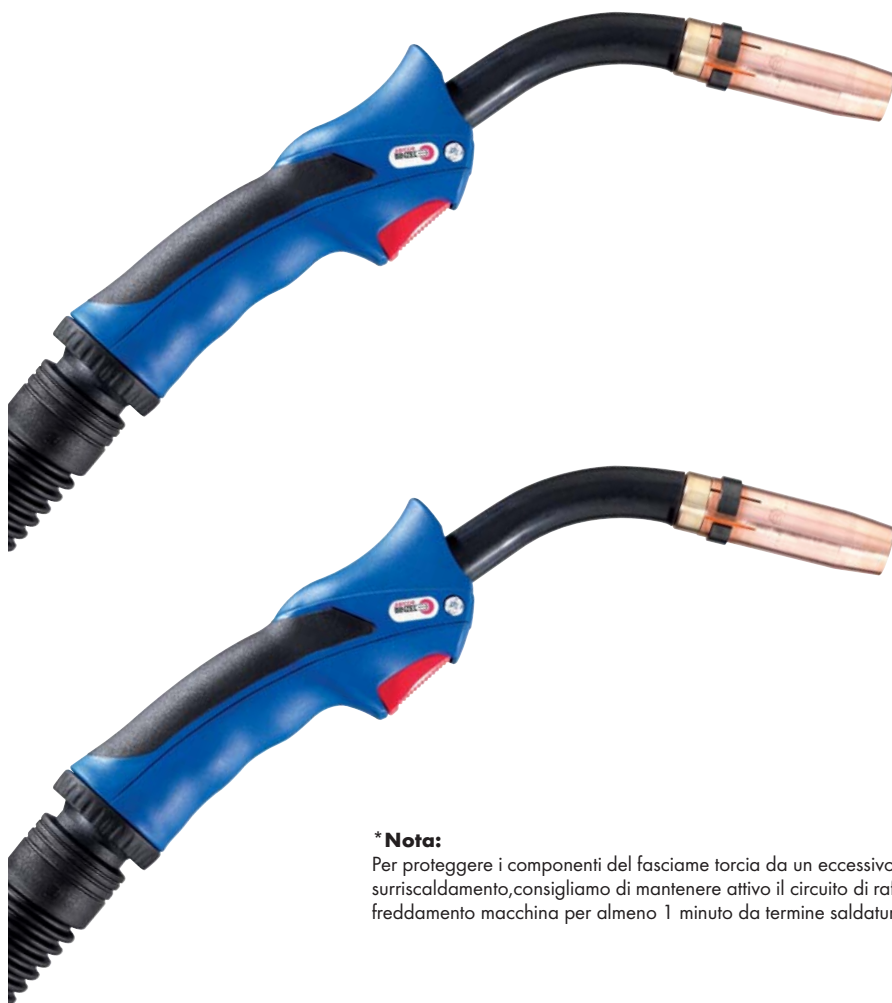

#### Torcia completa

Modello	Impugnatura	n° cod.			Mod.	Lancia n° cod.
		3 m	4 m	5 m		
ABIMIG® GRIP W 555 D	Tipo S	766.0526.1	766.0527.1	766.0528.1	50°	766.0532.1
ABIMIG® GRIP W 555	Tipo S	766.0529.1	766.0530.1	766.0531.1	50°	766.0533.1

# ABIMIG® GRIP W 555 D, ABIMIG® GRIP W 555

## Consumabili

### ABIMIG® GRIP W 555 D

### ABIMIG® GRIP W 555

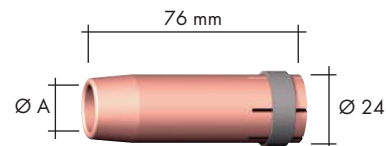
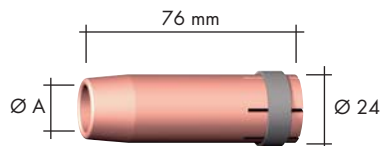

#### Ug.gas (10 pcs.)

	Ø A		Ø A
Cylindrical	Ø 20	145.0051	Ø 20
Conical	Ø 16	145.0085	Ø 16
Conical	Ø 14	145.0132	Ø 14

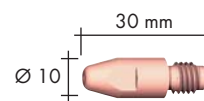
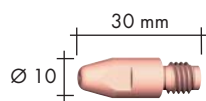

#### Ug.p.corr. (10 pcs.)

		M8	M8
E-Cu	Ø 0.8	140.0114	140.0114
	Ø 1.0	140.0313	140.0313
	Ø 1.2	140.0442	140.0442
	Ø 1.6	140.0587	140.0587
E-Cu per Al	Ø 0.8	141.0003	141.0003
	Ø 1.0	141.0008	141.0008
	Ø 1.2	141.0015	141.0015
	Ø 1.6	141.0022	141.0022
CuCrZr	Ø 0.8	140.0117	140.0117
	Ø 1.0	140.0316	140.0316
	Ø 1.2	140.0445	140.0445
	Ø 1.6	140.0590	140.0590

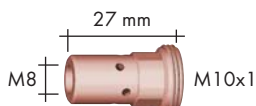

#### Supp.ug.p.corr.

M8	142.0201.10	-
----	-------------	---



#### Diffusore gas (5 pcs.)

Standard	030.0145	030.0145
Lunga durata	030.0037	030.0037
Ceramico	030.0190	030.0190

#### Guaine

#### per 3 m

#### per 4 m

#### per 5 m



Guaine	Ø 0.8	124.0011	124.0012	124.0015
	Ø 1.0	124.0026	124.0031	124.0035
	Ø 1.2	124.0026	124.0031	124.0035
	Ø 1.6	124.0041	124.0042	124.0042
Guaine PTFE	Ø 0.8	126.0005	126.0008	126.0011
	Ø 1.0	126.0021	126.0026	126.0028
	Ø 1.2	126.0021	126.0026	126.0028
	Ø 1.6	126.0039	126.0042	126.0045
Guaine grafite PTFE	Ø 0.8	127.0002	127.0003	127.0004
	Ø 1.0	127.0005	127.0007	127.0008
	Ø 1.2	127.0005	127.0007	127.0008
	Ø 1.6	127.0010	127.0012	127.0013

# MIG/MAG Welding Torches ABIMIG® GRIP W 555 / 555 D

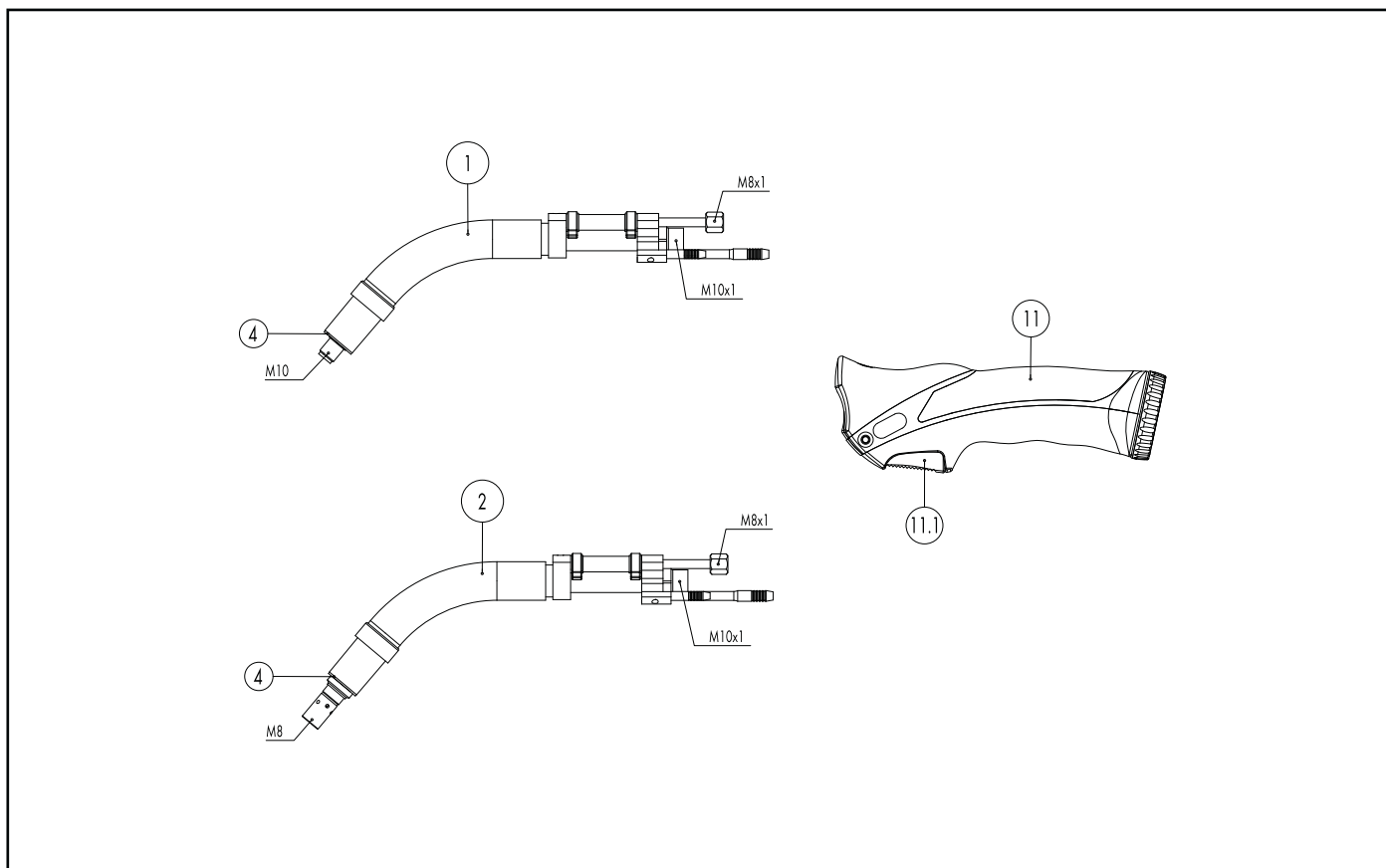

Pos.	Description	Units	Part-No.	Product-group
<b>Torch (D-Version)</b>				
	ABIMIG® GRIP W 555 D; type S; central adaptor WZ-2; 3.00 m		766.0526.1	1317
	ABIMIG® GRIP W 555 D; type S; central adaptor WZ-2; 4.00 m		766.0527.1	1317
	ABIMIG® GRIP W 555 D; type S; central adaptor WZ-2; 5.00 m		766.0528.1	1317
<b>Torch</b>				
	ABIMIG® GRIP W 555; type S; central adaptor WZ-2; 3.00 m		766.0529.1	1317
	ABIMIG® GRIP W 555; type S; central adaptor WZ-2; 4.00 m		766.0530.1	1317
	ABIMIG® GRIP W 555; type S; central adaptor WZ-2; 5.00 m		766.0531.1	1317
<b>Swan neck (D-Version)</b>				
1	Swan neck ABIMIG® GRIP W 555 D; 50j bent		766.0532.1	1309
<b>Swan neck</b>				
2	Swan neck ABIMIG® GRIP W 555; 50j bent		766.0533.1	1309
4	Insulator	20 Pcs.	766.0230	1395
<b>Handle GRIP</b>				
11	Handle GRIP type S with trigger cpl.		180.0132.1	1395
11.1	Trigger 2-pole GRIP	5 Pcs.	185.0107.5	1395
<b>Cable assembly</b>				
41	Power cable ABIMIG® GRIP / RAB GRIP (PVC) for 3.00 m		115.0581	1012
41	Power cable ABIMIG® GRIP / RAB GRIP (PVC) for 4.00 m		115.0582	1012
41	Power cable ABIMIG® GRIP / RAB GRIP (PVC) for 5.00 m		115.0583	1012
42	Wire conduit ABIMIG® GRIP / MB GRIP cpl. for 3.00 m		156.0275	1012
42	Wire conduit ABIMIG® GRIP / MB GRIP cpl. for 4.00 m		156.0276	1012
42	Wire conduit ABIMIG® GRIP / MB GRIP cpl. for 5.00 m		156.0277	1012
43	Control cable 2-pole	200 m	100.0019	4050
44	Trigger wire connector	20 Pcs.	175.0022	9010
45	Insulating sleeve	20 Pcs.	400.0119	1095

# MIG/MAG Welding Torches ABIMIG® GRIP W 555 / 555 D

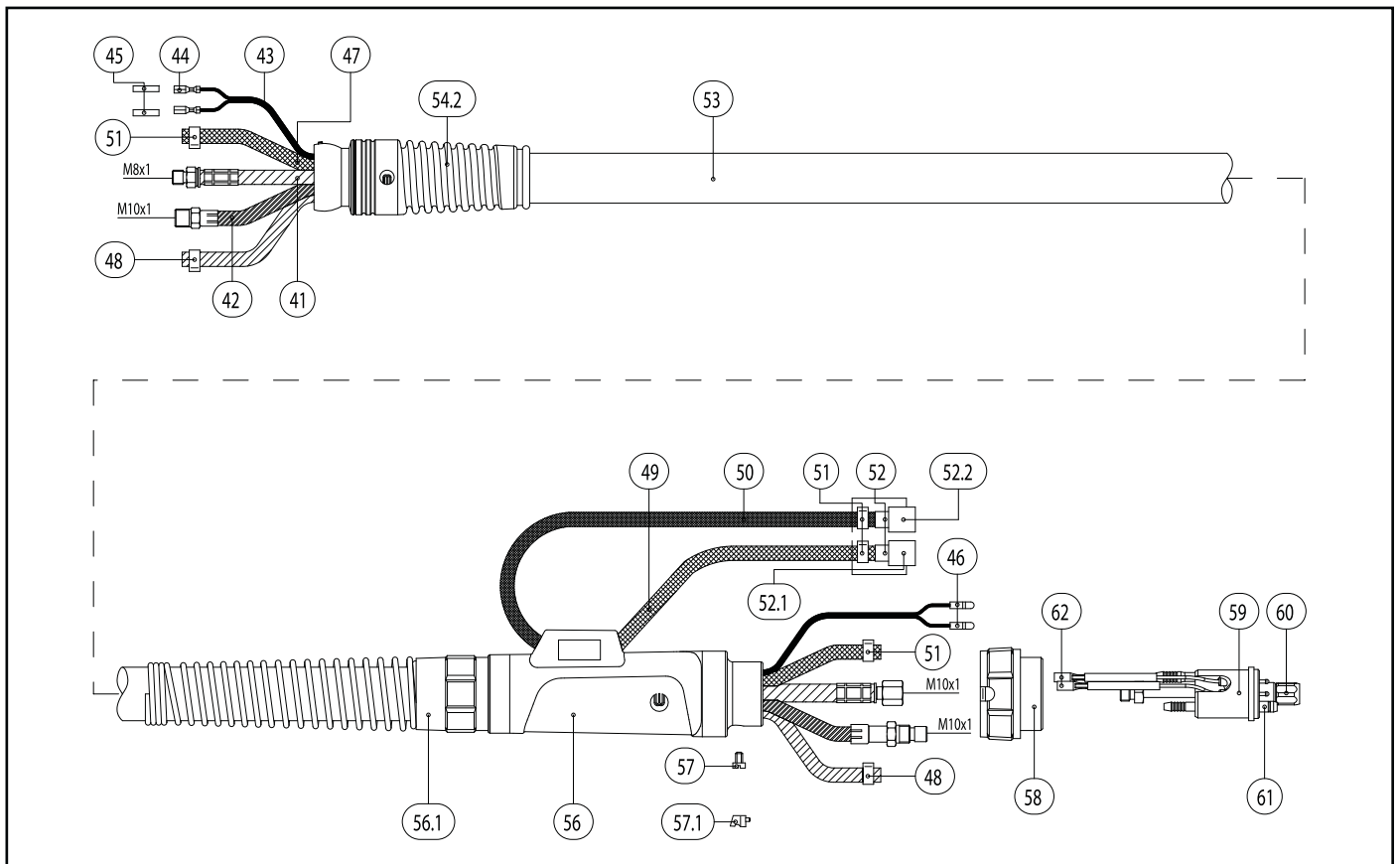

Pos.	Description	Units	Part-No.	Product-group
46	Plug	20 Pcs.	175.0004	9010
47	Hose 30 black ~ 4.9x1.5	100 m	109.0040	4050
48	Hose clamp ~ 8.7 mm	100 Pcs.	171.0002	9010
49	Hose 47 blue ~ 5.5x1.5	100 m	109.0057	4050
50	Hose 46 red ~ 5.5x1.5	100 m	109.0056	4050
51	Hose clamp ~ 9.0 mm with ring (mark 9.5)	100 Pcs.	173.0001	9010
52	Plug nipple ND 5 mm / ~ 6.0 mm	20 Pcs.	501.0114	9010
52.1	Fastener cap blue	20 Pcs.	501.2424	1095
52.2	Fastener cap red	20 Pcs.	501.2423	1095
53	Outer cover with cable support ~ 25x1.5 for 3.00 m		107.0079	1095
53	Outer cover with cable support ~ 25x1.5 for 4.00 m		107.0044	1095
53	Outer cover with cable support ~ 25x1.5 for 5.00 m		107.0080	1095
	Outer cover ~ 25x1.5	40 m	107.0004	4050
54.2	Ball joint cable protection MB GRIP / ABIMIG® GRIP W (liquid cooled)		400.1392.1	1095
	Inner ring for ABIMIG® / ABIMIG® GRIP / MB GRIP (liquid cooled)		400.0790	1095
56	Cable support machine side big cpl. ND 31		500.0342	9010
56.1	Cable support spring		500.0233	9010
56.1	Biclip inside		400.0328	9010
56.1	Biclip outside		400.0329	9010
57	Pan head screw M4x6	20 Pcs.	000.0552	9010
57.1	Screw cap 1	20 Pcs.	500.0251	9010
58	Adaptor nut M33x2		500.0213	9010
59	Central adaptor WZ-2		501.0015	9010
60	Coupling nut M10x1	10 Pcs.	501.0082	9010
61	O-Ring 4x1	20 Pcs.	165.0002	9010
62	Trigger wire connector; female	20 Pcs.	175.0003	9010

# MIG/MAG Welding Torches ABIMIG® GRIP W 555 / 555 D

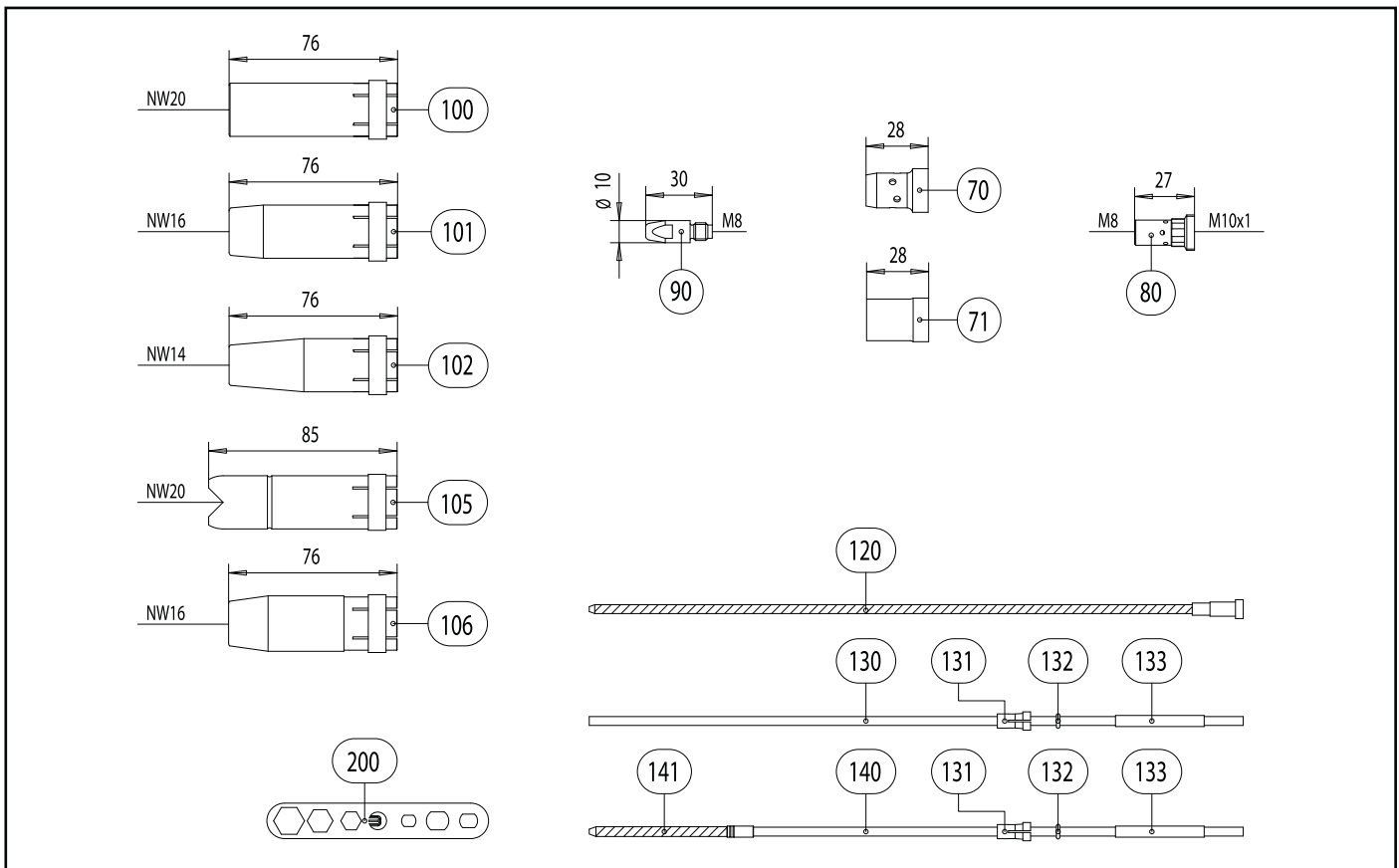

## Pos. Description

## Units

## Part-No.

## Product-group

Pos.	Description	Units	Part-No.	Product-group
<b>Wear parts ABIMIG® GRIP W 555 D / 555</b>				
70	Gas diffuser, white	10 Pcs.	030.0145	1032
70	Gas diffuser, long life	10 Pcs.	030.0037	1032
70	Gas diffuser, ceramic	10 Pcs.	030.0190	1032
71	Nozzle insulator	10 Pcs.	146.0013	1032
<b>Wear parts ABIMIG® GRIP W 555 D</b>				
80	Contact tip holder M8; 27.0 mm; CuCrZr	10 Pcs.	142.0201.10	1033
<b>Wear parts ABIMIG® GRIP W 555 D / 555</b>				
90	Contact tip M8 E-Cu; $\bar{\tau}$ 0.8 (10x30)	10 Pcs.	140.0114	1030
90	Contact tip M8 E-Cu; $\bar{\tau}$ 1.0 (10x30)	10 Pcs.	140.0313	1030
90	Contact tip M8 E-Cu; $\bar{\tau}$ 1.2 (10x30)	10 Pcs.	140.0442	1030
90	Contact tip M8 E-Cu; $\bar{\tau}$ 1.6 (10x30)	10 Pcs.	140.0587	1030
90	Contact tip M8 CuCrZr; $\bar{\tau}$ 0.8 (10x30)	10 Pcs.	140.0117	1031
90	Contact tip M8 CuCrZr; $\bar{\tau}$ 1.0 (10x30)	10 Pcs.	140.0316	1031
90	Contact tip M8 CuCrZr; $\bar{\tau}$ 1.2 (10x30)	10 Pcs.	140.0445	1031
90	Contact tip M8 CuCrZr; $\bar{\tau}$ 1.6 (10x30)	10 Pcs.	140.0590	1031
90	Contact tip M8 E-Cu; $\bar{\tau}$ 0.8 for alu wire (10x30)	10 Pcs.	141.0003	1030
90	Contact tip M8 E-Cu; $\bar{\tau}$ 1.0 for alu wire (10x30)	10 Pcs.	141.0008	1030
90	Contact tip M8 E-Cu; $\bar{\tau}$ 1.2 for alu wire (10x30)	10 Pcs.	141.0015	1030
90	Contact tip M8 E-Cu; $\bar{\tau}$ 1.6 for alu wire (10x30)	10 Pcs.	141.0022	1030
90	Contact tip M8 CuCrZr silver-plated; $\bar{\tau}$ 0.8 (10x30)	10 Pcs.	147.0117	1031
90	Contact tip M8 CuCrZr silver-plated; $\bar{\tau}$ 1.0 (10x30)	10 Pcs.	147.0316	1031
90	Contact tip M8 CuCrZr silver-plated; $\bar{\tau}$ 1.2 (10x30)	10 Pcs.	147.0445	1031
90	Contact tip M8 CuCrZr silver-plated; $\bar{\tau}$ 1.6 (10x30)	10 Pcs.	147.0590	1031
100	Gas nozzle; cylindrical; ND $\bar{\tau}$ 20.0	10 Pcs.	145.0051	1037
101	Gas nozzle; conical; ND $\bar{\tau}$ 16.0	10 Pcs.	145.0085	1037

# MIG/MAG Welding Torches ABIMIG® GRIP W 555 / 555 D

Pos.	Description	Units	Part-No.	Product-group
102	Gas nozzle; tapered; ND - 14.0	10 Pcs.	145.0132	1037
105	Spot weld gas nozzle; ND - 20.0	10 Pcs.	145.0179	1037
106	Gas nozzle; heavy duty; ND - 16.0 (only use with nozzle insulator)	10 Pcs.	145.0086	1037
120	Guide spiral liner insulated; 1.5/4.0; blue; for wire - 0.8; for 3.00 m		124.0137	1334
120	Guide spiral liner insulated; 1.5/4.0; blue; for wire - 0.8; for 4.00 m		124.0138	1334
120	Guide spiral liner insulated; 1.5/4.0; blue; for wire - 0.8; for 5.00 m		124.0139	1334
120	Guide spiral liner insulated; 2.0/4.5; red; for wire - 1.0 - 1.2; for 3.00 m		124.0111	1334
120	Guide spiral liner insulated; 2.0/4.5; red; for wire - 1.0 - 1.2; for 4.00 m		124.0112	1334
120	Guide spiral liner insulated; 2.0/4.5; red; for wire - 1.0 - 1.2; for 5.00 m		124.0113	1334
120	Guide spiral liner insulated; 2.5/4.5; yellow; for wire - 1.6; for 3.00 m		124.0114	1334
120	Guide spiral liner insulated; 2.5/4.5; yellow; for wire - 1.6; for 4.00 m		124.0115	1334
120	Guide spiral liner insulated; 2.5/4.5; yellow; for wire - 1.6; for 5.00 m		124.0116	1334
130	PTFE core liner 1.5/4.0; blue; wire electrode - 0.8 - 1.0; for 3.00 m		126.0005	1034
130	PTFE core liner 1.5/4.0; blue; wire electrode - 0.8 - 1.0; for 4.00 m		126.0008	1034
130	PTFE core liner 1.5/4.0; blue; wire electrode - 0.8 - 1.0; for 5.00 m		126.0011	1034
130	PTFE core liner 2.0/4.0; red; wire electrode - 1.0 - 1.2; for 3.00 m		126.0021	1034
130	PTFE core liner 2.0/4.0; red; wire electrode - 1.0 - 1.2; for 4.00 m		126.0026	1034
130	PTFE core liner 2.0/4.0; red; wire electrode - 1.0 - 1.2; for 5.00 m		126.0028	1034
130	PTFE core liner 2.7/4.7; yellow; wire electrode - 1.6; for 3.00 m		126.0039	1034
130	PTFE core liner 2.7/4.7; yellow; wire electrode - 1.6; for 4.00 m		126.0042	1034
130	PTFE core liner 2.7/4.7; yellow; wire electrode - 1.6; for 5.00 m		126.0045	1034
130	PTFE carbon core liner 1.5/4.0; wire electrode - 0.8 - 1.0; for 3.00 m		127.0002	1034
130	PTFE carbon core liner 1.5/4.0; wire electrode - 0.8 - 1.0; for 4.00 m		127.0003	1034
130	PTFE carbon core liner 1.5/4.0; wire electrode - 0.8 - 1.0; for 5.00 m		127.0004	1034
130	PTFE carbon core liner 2.0/4.0; wire electrode - 1.0 - 1.2; for 3.00 m		127.0005	1034
130	PTFE carbon core liner 2.0/4.0; wire electrode - 1.0 - 1.2; for 4.00 m		127.0007	1034
130	PTFE carbon core liner 2.0/4.0; wire electrode - 1.0 - 1.2; for 5.00 m		127.0008	1034
130	PTFE carbon core liner 2.7/4.7; wire electrode - 1.6; for 3.00 m		127.0010	1034
130	PTFE carbon core liner 2.7/4.7; wire electrode - 1.6; for 4.00 m		127.0012	1034
130	PTFE carbon core liner 2.7/4.7; wire electrode - 1.6; for 5.00 m		127.0013	1034
131	Nipple for core liner at - 4.0	20 Pcs.	131.0001	1095
131	Nipple for core liner at - 4.7	20 Pcs.	131.0002	1095
132	O-Ring 3.5x1.5	20 Pcs.	165.0008	9010
133	Guide tube for core liners up to - 4.0 (200 mm)	10 Pcs.	129.0461	1095
140	Combined wire guide cpl. polyamide/brass; wire - 1.0 - 1.2; for 3.00 m		128.M002	1034
140	Combined wire guide cpl. polyamide/brass; wire - 1.0 - 1.2; for 4.00 m		128.M003	1034
140	Combined wire guide cpl. polyamide/brass; wire - 1.0 - 1.2; for 5.00 m		128.M004	1034
141	Brass spiral made up with sleeve (200 mm)	10 Pcs.	001.0305	1095
200	Spanner Standard		191.0001	9010